

Hitachi Portable Biometric Reader Enrolment and Authentication Guide

How to place your finger.

- Place the device on a stable surface such as a desk, it is not recommend using it while standing.
- Place the device on the same side as the authenticating hand.
- Place the whole elbow on the desk (if the desk is not deep enough for the elbow, please ensure the whole of forearm is supported on the desk).



Hitachi Portable Biometric Reader Enrolment and Authentication Guide

How to place your finger.

For enrolment and authentication,

1. Keep your hand relaxed with the fingers comfortably spread.
2. Place your finger on the base finger rest. Middle finger is recommended.
3. Slide your finger up to the fingertip rest.
4. Do not press it too hard.

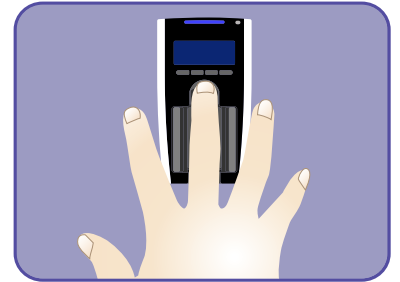
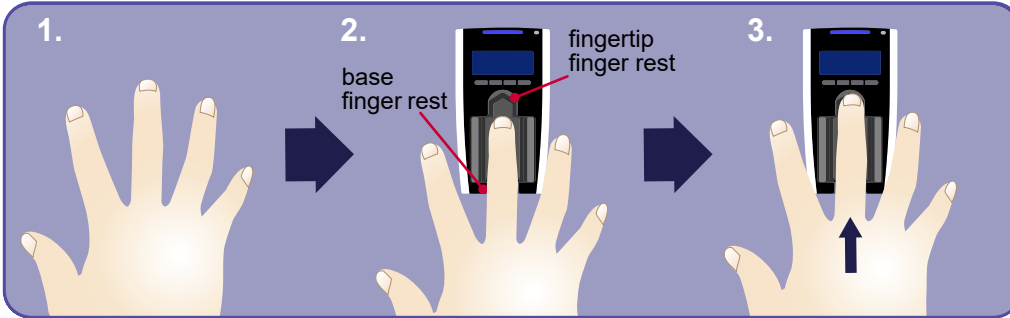

If you are unable to complete enrolment / authentication, please check the following items.

1. Finger should not touch the scanning area.
2. Finger should not over or under reach the finger rest. Too short Too far
3. Finger should not be placed at an angle.
4. Finger should not be too close to one side.
5. Finger should not be tilted.
6. Finger should not be floating above the device.
7. Finger should not be pressed down.
8. Biometric reader should not be exposed to strong light.

- If enrolment /authentication fails, please remove your finger then try placing it correctly again.
- If frequent authentication failures occur, the quality of the enrolled finger vein data may be poor. To fix this, the current data should be deleted and your finger enrolled again.

The following conditions may cause enrolment or authentication failures.

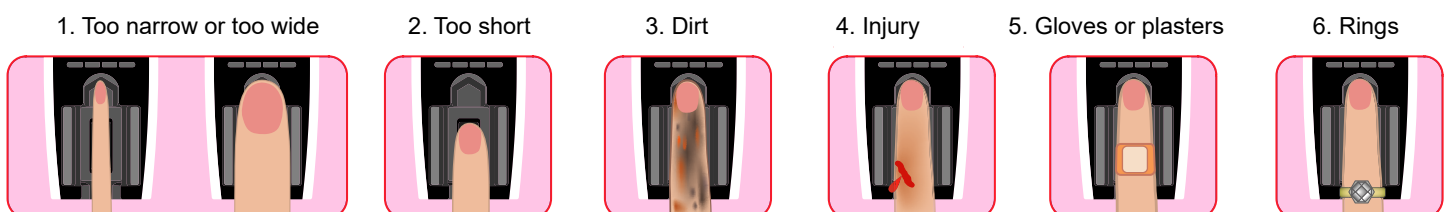

Finger width should be 10-25mm (0.4-1inch) .

7. Note that the biometric reader is not designed for use by young children.